

Straight Female Couplings

GAI-G

Dimensions in mm

DIN Fittings

Metric Tube end as per ISO 8434

Female BSPP (G) threads

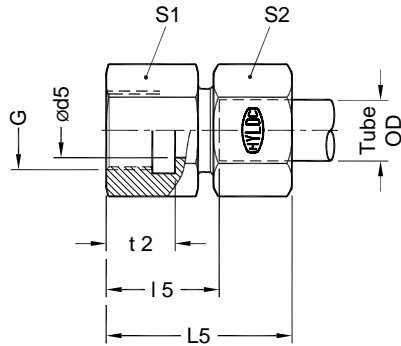

| Part No. | Series | Tube od | G | ød5 | t 2 | I 5 | L 5 | S 1 | S 2 |
|-----------------|---------------------------|---------------------------|---------|-------|------|------|------|------|-----|
| GAI06PLG | Light L 250 bar | 6 | G 1/8 | 4 | 12.0 | 19.0 | 34.5 | 14 | 14 |
| GAI08PLG | | 8 | G 1/4 | 6 | 17.0 | 24.0 | 39.0 | 19 | 17 |
| GAI10PLG | | 10 | G 1/4 | 8 | 17.0 | 25.0 | 40.5 | 19 | 19 |
| GAI12PLG | | 12 | G 3/8 | 10 | 17.0 | 26.0 | 41.0 | 24 | 22 |
| GAI15PLG | | 15 | G 1/2 | 12 | 20.0 | 31.0 | 47.0 | 27 | 27 |
| GAI18PLG | 160 bar | 18 | G 1/2 | 15 | 20.0 | 30.5 | 47.5 | 27 | 32 |
| GAI22PLG | | 22 | G 3/4 | 19 | 22.0 | 35.5 | 52.5 | 36 | 36 |
| GAI28PLG | | 28 | G 1 | 24 | 24.5 | 38.0 | 56.0 | 41 | 41 |
| GAI35PLG | 100 bar | 35 | G1.1/4 | 30 | 26.5 | 41.0 | 64.0 | 55 | 50 |
| GAI42PLG | | 42 | G1.1/2 | 36 | 28.5 | 42.5 | 66.0 | 60 | 60 |
| GAI06PSG | | Heavy S 630 bar | 6 | G 1/4 | 4 | 17.0 | 26.0 | 41.5 | 19 |
| GAI08PSG | 8 | | G 1/4 | 5 | 17.0 | 26.0 | 41.0 | 19 | 19 |
| GAI10PSG | 10 | | G 3/8 | 7 | 17.0 | 26.5 | 43.5 | 24 | 22 |
| GAI12PSG | 12 | | G 3/8 | 8 | 17.0 | 26.5 | 43.0 | 24 | 24 |
| GAI16PSG | 400 bar | | 16 | G 1/2 | 12 | 20.0 | 31.5 | 50.5 | 30 |
| GAI20PSG | | 20 | G 3/4 | 16 | 22.0 | 34.5 | 57.0 | 36 | 36 |
| GAI25PSG | | 25 | G 1 | 20 | 24.5 | 37.5 | 62.5 | 41 | 46 |
| GAI30PSG | 250 bar | 30 | G 1.1/4 | 25 | 26.5 | 42.0 | 70.0 | 55 | 50 |
| GAI38PSG | | 38 | G 1.1/2 | 32 | 28.5 | 43.5 | 75.0 | 60 | 60 |

* Dimensions given are approx figures with tightened nut.